

KK79-7 KK79 - Sheeting Clip (Galvanized Steel)

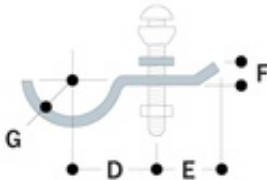

This fitting is used to attach profiled sheeting material to pipe. The fitting is supplied with the following hardware: one M6x50mm roofing bolt, one M6 square nut, and one M6 lock washer. BZP finish. Ø indicates diameter of bolt hole.

Part	Weight	A	D	E	F	G	diameter of bolt hole
79-7	0.18 lbs.	7	1.81 in.	1.34 in.	0.31 in.	0.83 in.	0.31 in.