

KK72-8 KK72 - Stair Tread Support (Galvanized Steel)

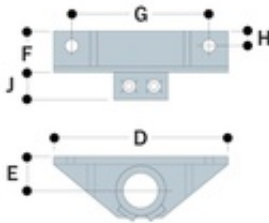

KK72 is a stair tread support suitable for most types of stair tread, including timber, open steel and checker plate. Fixing of the treads is by two bolt holes in each fitting. Ø indicates diameter of fixing holes. (Special Order Only) If KK72 fittings are to be used for a permanent application or subjected to high loads, the stair tread support pipe which is located at its ends with a single set screw, should be drilled and pinned to avoid rotational slip.

Part	Weight	A	D	E	F	G	H	J	Ø
72-8	2.75 lbs.	8	7.99 in.	1.54 in.	2.01 in.	6.02 in.	0.79 in.	1.3 in.	0.47 in.